

YEAR 11 CUSTOM WORKBOOK Order Form

School name*

HOD name*

School order No.

Email*

Phone*

School delivery address*

Street/Road

Suburb

City

Postcode

Workbook quantity:

Select your chosen worksheets below and email the completed form to: info@lighthousegraphics.co.nz

PRICING

Standard charge for each workbook covers: Front cover, index, padding with backing card and processing \$3.00.

Price per worksheet \$0.30. e.g. Customised workbook with 20 worksheets = \$9.00 (20 x \$0.30 + \$3.00)

PLEASE NOTE:

10% discount offered for all single orders over \$1000.

Minimum of 15 workbooks per school at each level. Special orders for smaller schools – please phone or email for details.

YEAR 11 WORKSHEETS (PLEASE TICK BOXES FOR CHOSEN WORKSHEETS)

1. FREEHAND SKETCHING

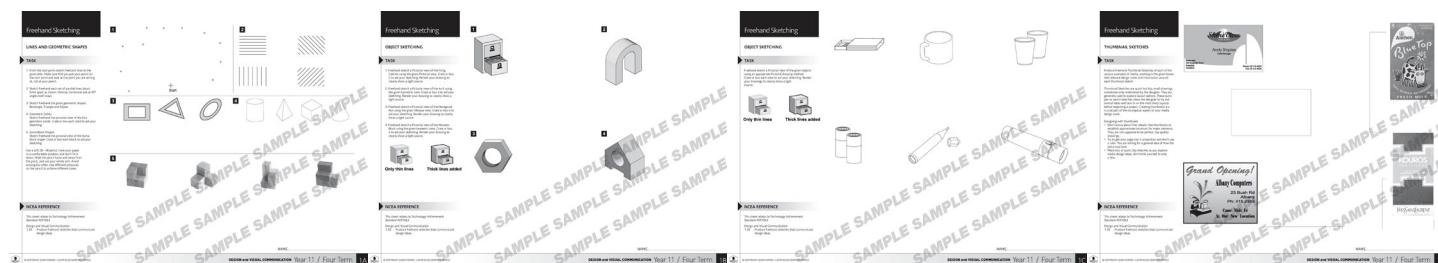

1A - Lines and Geometric Shapes

1B - Object Sketching

1C - Object Sketching

1D - Thumbnail Sketches

2. COLOUR THEORY - MODES & MEDIA

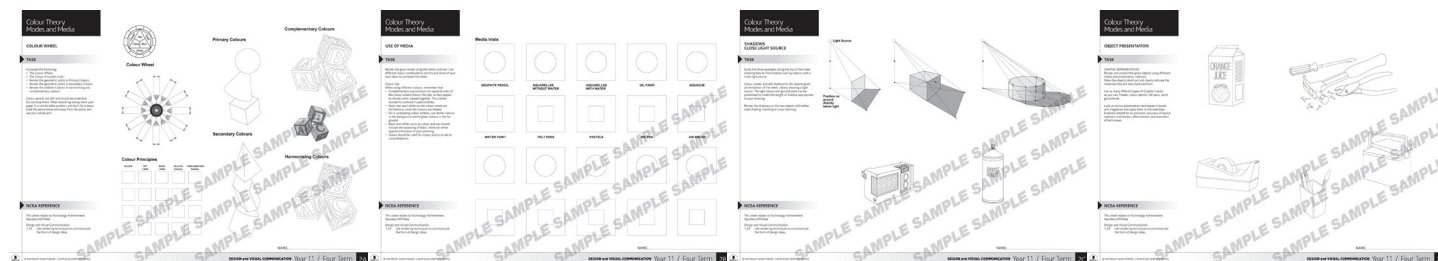

2A - The colour wheel

2B - Use of Media

2C - Shadows - Close Light Source

2D - Object Presentation



2E - Sketching - Object Presentation

2F - Visual Design Principles and Elements

2G - Design Evaluations - Lamp, Chair and Bauhaus Logo

3. GEOMETRIC CONSTRUCTIONS 1

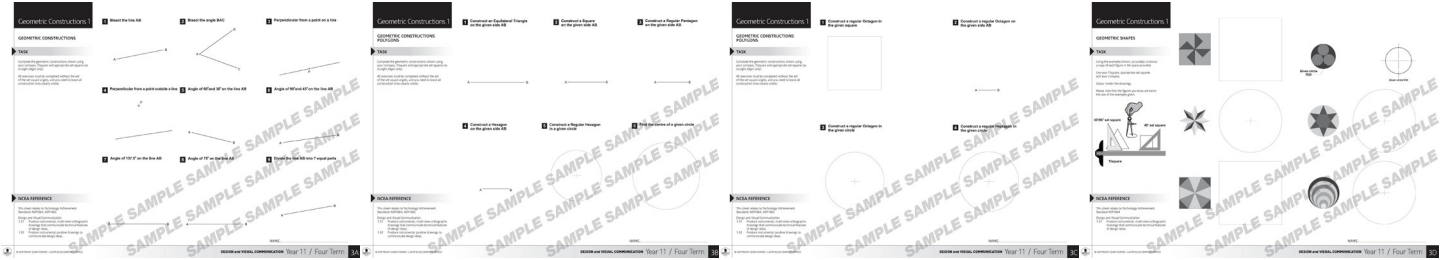

3A - Geometric Constructions

3B - Geometric Constructions - Polygons

3C - Geometric Constructions - Polygons

3D - Geometric Shapes

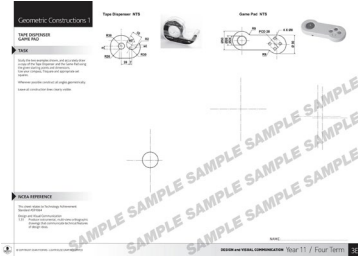

3E - Tape Dispenser - Tape Dispenser and Game Pad

4. PICTORIALS

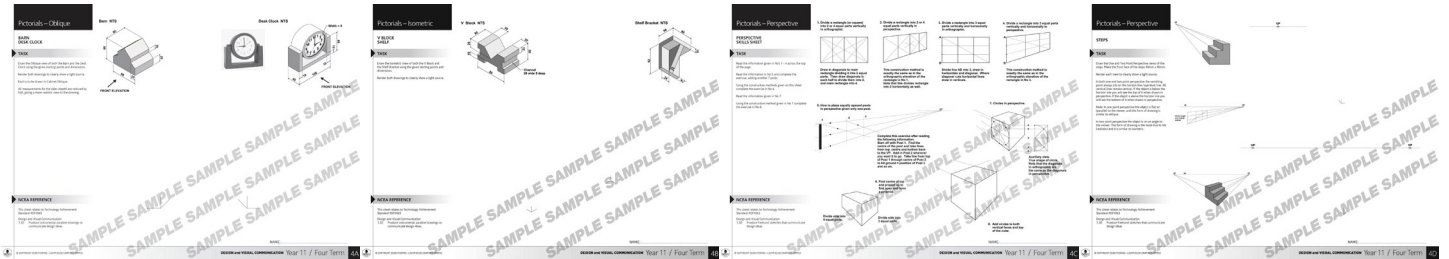

4A - Oblique - Barn and Desk Clock

4B - Isometric - V Block and Shelf

4C - Perspective Skills Sheet

4D - One and Two Point Perspective - Steps



4E - One Point Perspective - Kitchen

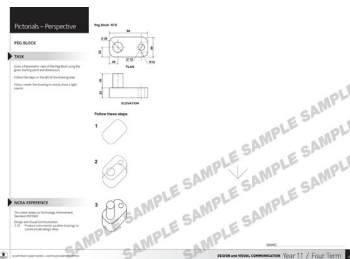

4F - Planometric - Peg Block

5. ORTHOGRAPHIC PROJECTION

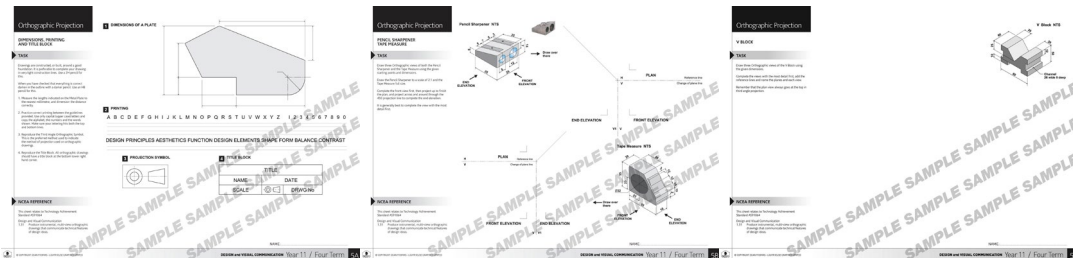

5A - Dimensions, Printing and Title Block

5B - Orthographic - Pencil Sharpener and Tape Measure

5C - Orthographic - V Block

6. SURFACE DEVELOPMENT

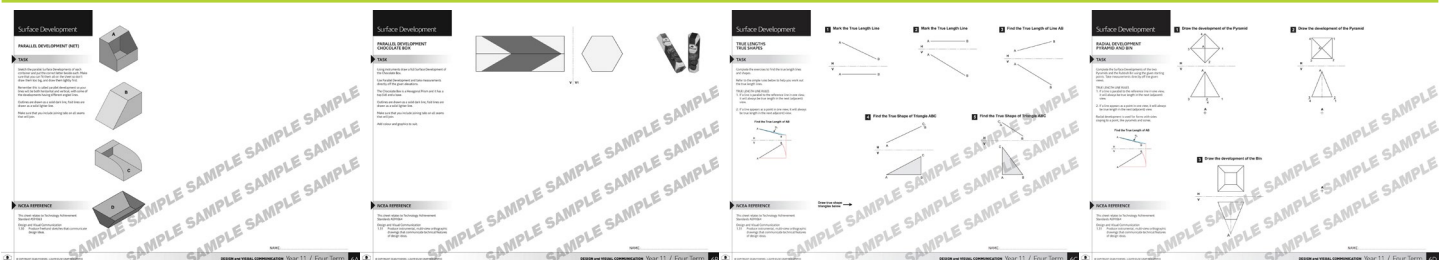

6A - Parallel Development

6B - Parallel Development - Chocolate Box

6C - True Lengths and True Shapes

6D - Radial Development - Pyramid and Bin

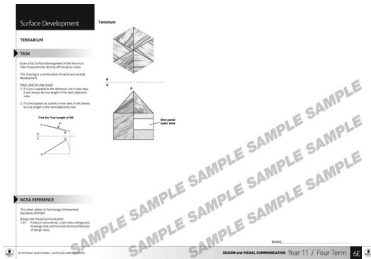

6E - Radial Development - Terrarium

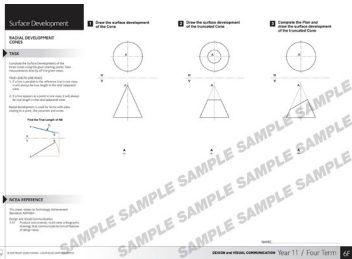

6F - Radial Development - Cones

7. ISOMETRIC CIRCLES

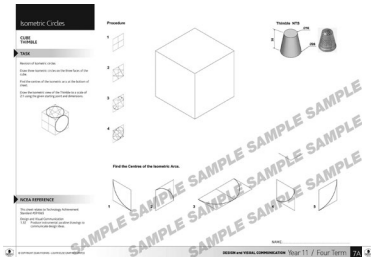

7A - Isometric Circles - Cube and Thimble

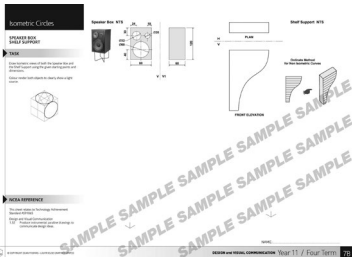

7B - Speaker Box and Shelf Support

8. GEOMETRIC CONSTRUCTIONS 2

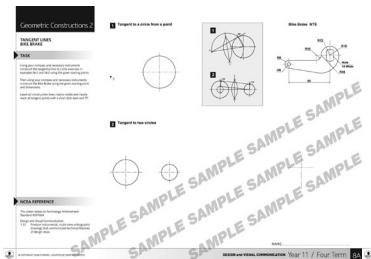

8A - Tangent Lines and Bike Brake

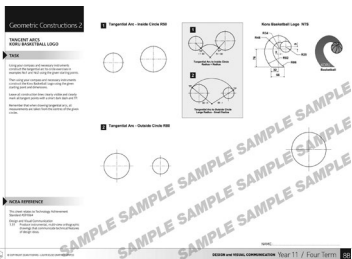

8B - Tangent Arcs and Koru Basketball Logo

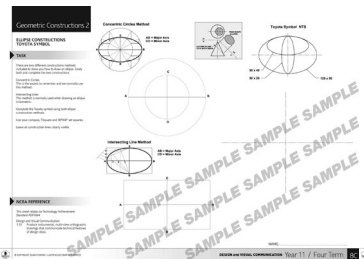

8C - Ellipse Constructions and Toyota Symbol

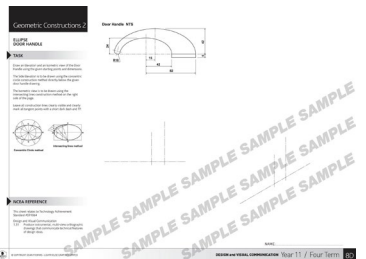

8D - Ellipse - Door Handle

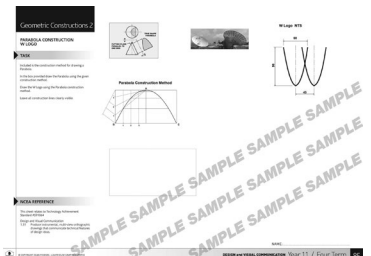

8E - Parabola Construction - W Logo

9. ORTHOGRAPHIC PROJECTION - SECTIONED VIEWS

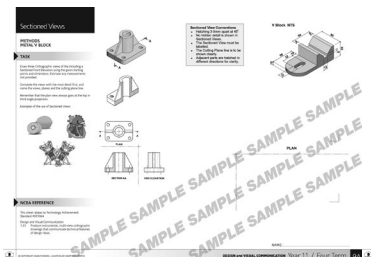

9A - Sectioning Methods - Metal V Block

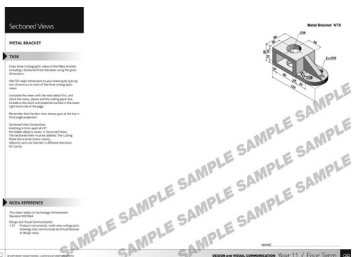

9B - Metal Bracket

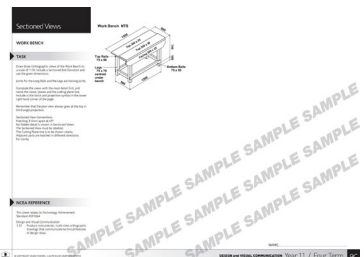

9C - Work Bench

10. EXPLODED DRAWINGS - ISOMETRIC PROJECTION

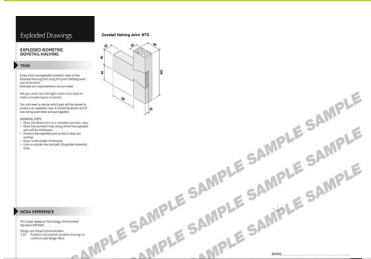

10A - Exploded Isometric - Dovetail Housing

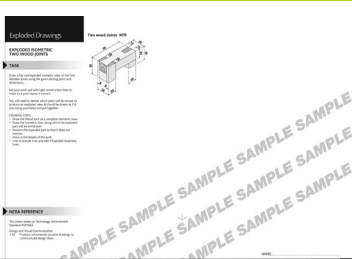

10B - Exploded Isometric - Two Wood Joints

11. ORTHOGRAPHIC PROJECTION - TRUE SHAPES

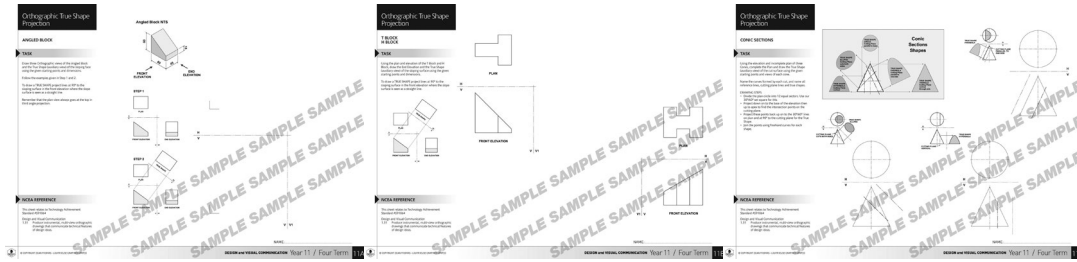

11A - Angled Block

11B - T Block and H Block

11C - Conic Sections